



SAN JOAQUIN COUNTY PUBLIC HEALTH LABORATORY (SJCPHL)

1601 EAST HAZLETON AVE. STOCKTON, CA 95205.

Phone: 209-468-3460

**CARBAPENEMASE (CARBA-R) TESTING: RECTAL OR PERIRECTAL SWABS COLLECTION
PROCEDURE**

Use the following procedure for collection and submission of clinical specimens for CARBA-R testing.

I. Supplies needed (can be provided by SJCPHL):

1. Copan dual swabs/Copan Liquid Stuart Transystem
2. Biohazard labelled Zip lock bags with outer sleeve
3. Requisition form (fill out all the fields). For Web Portal users: Print out a copy of the online submission.

1



2



3



II. Clinical Specimens: Rectal or Perirectal swabs

Note: Rectal swabs and Perirectal swabs should not be over-soiled. (Fig. 1)



Fig. 1

III. Collection of specimens:

1. Use only the Copan dual swabs/Copan Liquid Stuart Transystem.
(Directions for use are printed on each Transystem unit along with descriptive diagrams.)
2. Peel open the Transystem sterile pouch at the point marked "Peel Here". (Fig. 2)
3. Remove cap from transport tube. (Fig. 2)

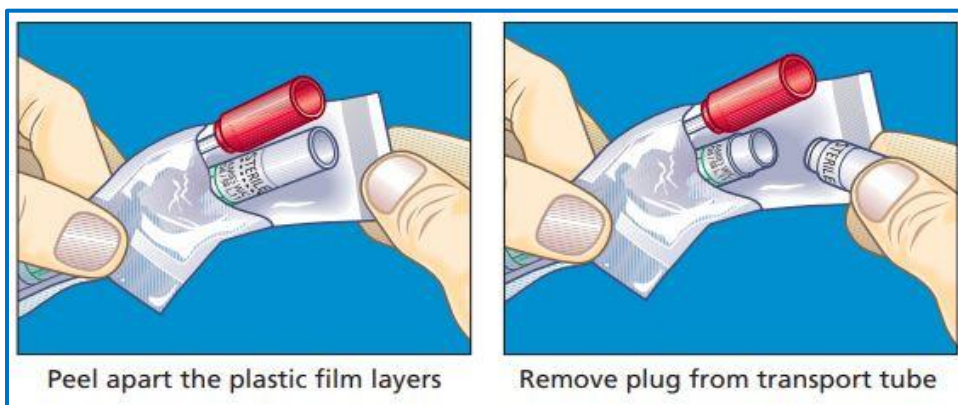

Fig. 2



4. Remove the applicator swab and collect specimen. (Fig. 3)

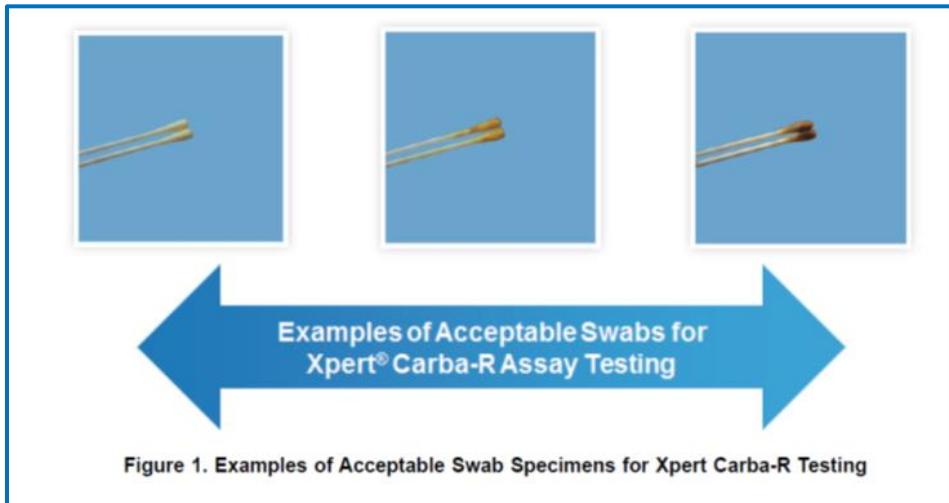

Fig. 3

5. Place applicator swab in transport tube and replace the cap to completely seal (Fig. 4)
6. Record patient's name and information on tube label. (Fig. 4)



Fig. 4

7. Place specimens **inside the zip lock** specimen bag.



← *Specimens kept
inside the zip lock bag*



8. Complete all the required information on the laboratory requisition form. (Note: Web Portal users will use and print out a copy of the completed online submission for the laboratory form).
9. Place laboratory form **in the outer sleeve** of zip-lock bag to separate it from the specimen, in case of leakage. (Fig. 5)

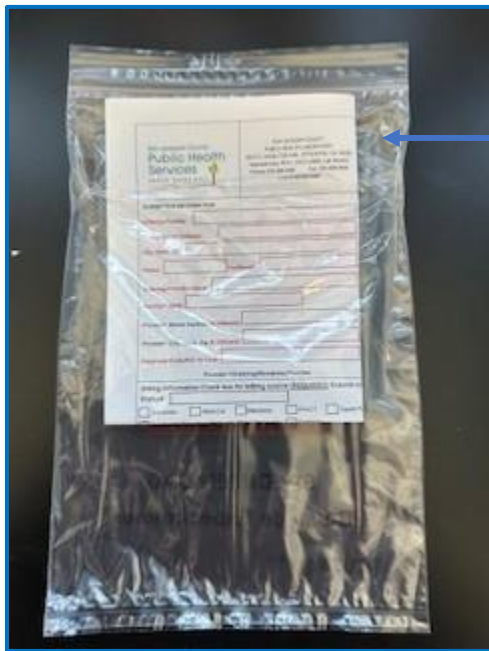

*Form kept in the
Outer sleeve*

Fig. 5

10. Store the specimen at 15-28°C (59-82.4°F) for up to 5 days.
11. Coordinate with the SJCPHL for either specimen pickup or specimen drop off. Specimens must be transported at 15-28°C. If shipping, ship as Category B.



IV. Unacceptable specimens that may cause specimen rejection:

- Using media not provided with collection kit.
- Broken transport device.
- Unacceptable amount of sample on swabs.
- Specimens received at SJPHL collected >5 days prior.
- Requisition form incomplete.
- Specimens received without a test requisition form.
- Unlabeled or mislabeled specimen.
- Specimen too old or in poor condition.
- Specimen submitted on grossly outdated media or transport kits.
- No specimen received with test requisition form.
- Specimen leaked during transport.